

EFBV90, BORA Ecotube shallow, vertical 90° bend

[> Web link](#)

Article no.
40.001.782.00

Price CHF
47.- D excl. VAT

Product description

EFBV90 BORA Ecotube bend 90° flat vertical incl. sealing material

Technical data

Dimensions (W x D x H)

255 x 139 x 139 mm

Material characteristics

V0 according to UL94

B1 according to DIN 4102-1

Number of required seals*

2 x EFD

Weight

0,35 kg

* Gaskets are included in the price and delivery.

Accessory (ordered separately)

EFMS mounting bracket set

Planning tips

Moulded part with two shallow sleeve forms

For use with units with a BORA Ecotube duct connection (245 x 89 mm). To connect BORA Ecotube to Naber fittings (222 x 89 mm), an adapter (EFA, 40.001.779) is available / to be ordered separately.

EFBH90

BORA Ecotube Bogen 90° flach horizontal

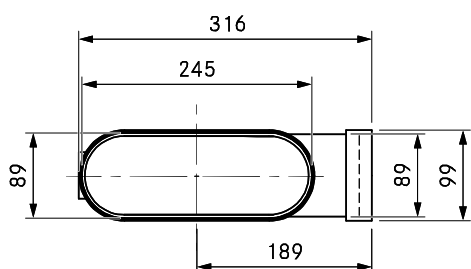
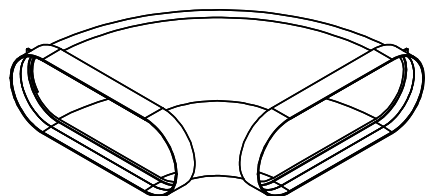

Technische Daten

Abmessungen (BxTxH)	316 x 316 x 99 mm
Materialeigenschaft	V0 nach UL94, B1 nach DIN 4102-1
Anzahl notwendiger Dichtungen	2 x EFD
Gewicht	0,75 kg

Zubehör

- Montagebügel Set EFMS

Planungshinweise

- Formteil mit zwei Muffenausbildungen flach

EFBV90

BORA Ecotube Bogen 90° flach vertikal

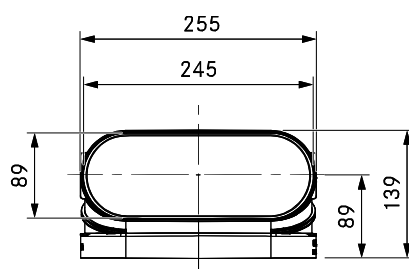
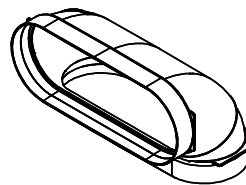

Technische Daten

Abmessungen (BxTxH)	255 x 139 x 139 mm
Materialeigenschaft	V0 nach UL94, B1 nach DIN 4102-1
Anzahl notwendiger Dichtungen	2 x EFD
Gewicht	0,35 kg

Zubehör

- Montagebügel Set EFMS

Planungshinweise

- Formteil mit zwei Muffenausbildungen flach